

\$849,800 - 37 51128 Rge Road 261, Rural Parkland County

MLS® #E4437000

\$849,800

4 Bedroom, 3.00 Bathroom, 1,713 sqft

Rural on 6.23 Acres

Beaverbrook Park, Rural Parkland County, AB

The ultimate in privacy on your own 6+ acre estate. This beautiful home has been extremely well cared for and is a pleasure to view. There are large and spacious rooms throughout. Large country kitchen with an abundance of countertop space, huge family dining area. Large living room with fireplace. Three bedrooms on the main floor master bedroom has a five piece ensuite as well as the four piece bathroom. The lower level is fully finished with a large recreation room with fire place, games area with large wet bar, fourth bedroom and 3 piece bath. From this level you can access the oversized double attached garage. The land is gently rolling with a walking path around the perimeter, a firepit area, an oversized additional double garage or shop 24'x28', shed and smoke house. Easy choice!

Built in 1993

Essential Information

MLS® #	E4437000
Price	\$849,800
Bedrooms	4
Bathrooms	3.00
Full Baths	3

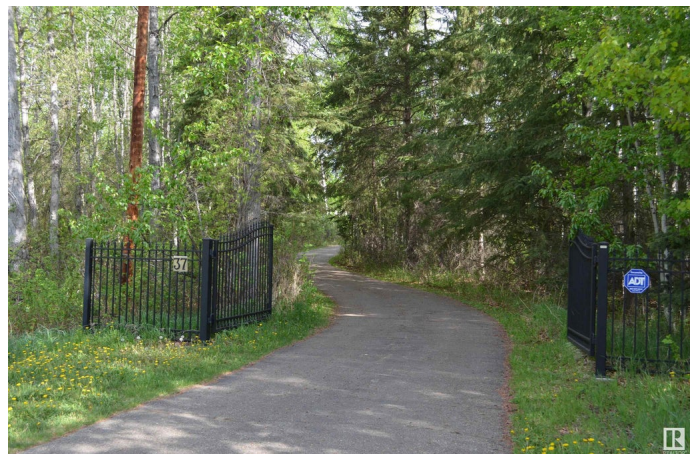

Square Footage	1,713
Acres	6.23
Year Built	1993
Type	Rural
Sub-Type	Detached Single Family
Style	Bi-Level
Status	Active

Community Information

Address	37 51128 Rge Road 261
Area	Rural Parkland County
Subdivision	Beaverbrook Park
City	Rural Parkland County
County	ALBERTA
Province	AB
Postal Code	T7Y 1B8

Amenities

Features	Closet Organizers, Detectors Smoke, Exterior Walls- 2"x6", Fire Pit, No Animal Home, No Smoking Home, Vinyl Windows, See Remarks
----------	--

Interior

Interior Features	ensuite bathroom
Heating	Fan Coil, In Floor Heat System, Natural Gas
Stories	2
Has Basement	Yes
Basement	Full, Finished

Exterior

Exterior	Wood
Exterior Features	Backs Onto Park/Trees, Golf Nearby, Private Setting, See Remarks
Construction	Wood
Foundation	Concrete Perimeter

Additional Information

Date Listed	May 16th, 2025
Days on Market	32
Zoning	Zone 90

DATA IS DEEMED RELIABLE BUT IS NOT GUARANTEED ACCURATE BY THE REALTORS® ASSOCIATION OF

EDMONTON. COPYRIGHT 2025 BY THE REALTORS® ASSOCIATION OF EDMONTON. ALL RIGHTS RESERVED.Trademarks are owned or controlled by the Canadian Real Estate Association (CREA) and identify real estate professionals who are members of CREA (REALTOR®, REALTORS®) and/or the quality of services they provide (MLS®, Multiple Listing Service®)

Listing information last updated on June 17th, 2025 at 3:47am MDT